



Part# 1002508
11/29/2005

0500 PUMP CONVERSION KIT

OWNERS MANUAL



This manual contains important information concerning the installation and operation of the product listed above.
Read manual thoroughly and keep for future reference

INSTRUCTIONS

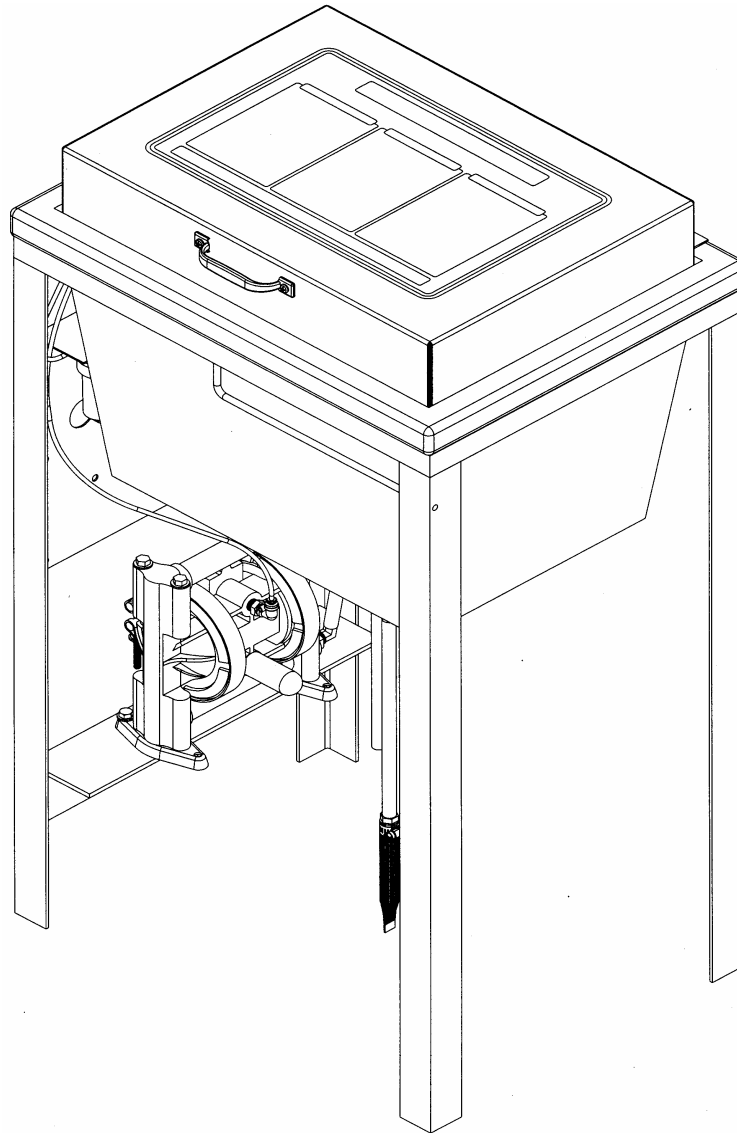

Herkules Equipment Corporation
248-960-7100

2760 Ridgeway Court
800-444-4351

Walled Lake, MI 48390-1662 USA
Fax 248 960-7109

Patents USA 4793369, 4960142, 5174317, 5193561, 5485860 Canada 1299468 Made in the USA
website: www.herkules.us e-mail: info@herkules.us

Table of Contents

Warnings	3-4
Assembly Instructions	5-7
Kit Information	7
Troubleshooting	8
Notes	8

Warning Symbol



This symbol alerts you to the possibility of serious injury or death if you do not follow the instructions.

Caution Symbol



This symbol alerts you to the possibility of damage to or destruction of equipment if you do not follow the instructions.

Serial Number _____

Model Number _____

Purchase Date _____

Distributor _____



WARNING



EQUIPMENT MISUSE HAZARD

Equipment misuse can cause the equipment to rupture, malfunction, or start unexpectedly and result in serious injury.

- This equipment is for professional use only.
- Read all instruction manuals, tags, and labels before operating the equipment.
- Use the equipment only for its intended use.
- Do not alter or modify this equipment.
- Do not exceed the maximum working pressure of the lowest rated system component.
- Do not operate the gun washer at a pressure above the maximum working pressure rating of the gun(s) being cleaned.
- Route the hoses away from traffic areas, sharp edges, moving parts, and hot surfaces.
- Do not use the hoses to pull the equipment.
- Do not move pressurized equipment.
- Use fluids or solvents that are compatible with the equipment wetted parts. Read the fluid and solvent manufacturer's warnings
- Comply with all applicable local, state and national fire, electrical and other safety regulation.



PRESSURIZED EQUIPMENT HAZARD

Spray from hose leaks, ruptured components, or from operating the gun washer with an open lid can splash fluid in the eyes or on the skin and cause serious injury.

- A safety device has been installed to shut off the pump when the gun washer lid is opened. Do not tamper with or alter this device.
- Open the gun washer lid slowly.
- Do not prop the gun washer lid open with an object or by any other means.
- Do not stop or deflect fluid leaks with your hand, body, glove, or rag.
- Tighten all fluid connections before operating the equipment.
- Replace worn, damaged, or loose parts immediately.



WARNING



FIRE AND EXPLOSION HAZARD



Improper grounding, poor air ventilation, open flames, or sparks can cause a hazardous condition and result in fire or explosion and serious injury.

- Ground the equipment. See Installation for grounding procedure.
- Provide fresh air ventilation to avoid the build up of flammable fumes from the solvent.
- Extinguish all open flames or pilot lights in the gun washer area.
- Disconnect all electrical equipment in the gun washer area.
- Keep the gun washer area free of debris, including solvent, rags, and gasoline.
- Do not turn on any light switch in the gun washer area while operating or if fumes are present.
- Do not smoke in the gun washer area.
- Do not operate a gasoline engine in the gun washer area.
- Follow the gun manufacturer's solvent and other cleaning recommendations.
- Use solvent with the highest possible flash point.
- If there is any static sparking while using the equipment, **stop operation immediately**. Identify and correct the problem.
- Drain the solvent into a proper storage container when gun washer(s) is not in use.



TOXIC FLUID HAZARD

Hazardous fluids or toxic fumes can cause serious injury or death if splashed in eyes or on the skin, swallowed, or inhaled.

- Know the specific hazards of the fluid you are using. Read the fluid manufacturer's warnings.
- Store hazardous fluid in an approved container. Dispose of hazardous fluid according to all local, state and national guidelines.
- Wear the appropriate protective clothing, gloves, eyewear and respirator.
- Pipe and dispose of the exhaust air safely. If diaphragm fails, the fluid may be exhausted along with the air.

Assembly

For units with the strainer assembly shown in fig. 1, it is necessary to replace the bulkhead at the base of the tub. If the unit does not have the assembly, skip to step 3.

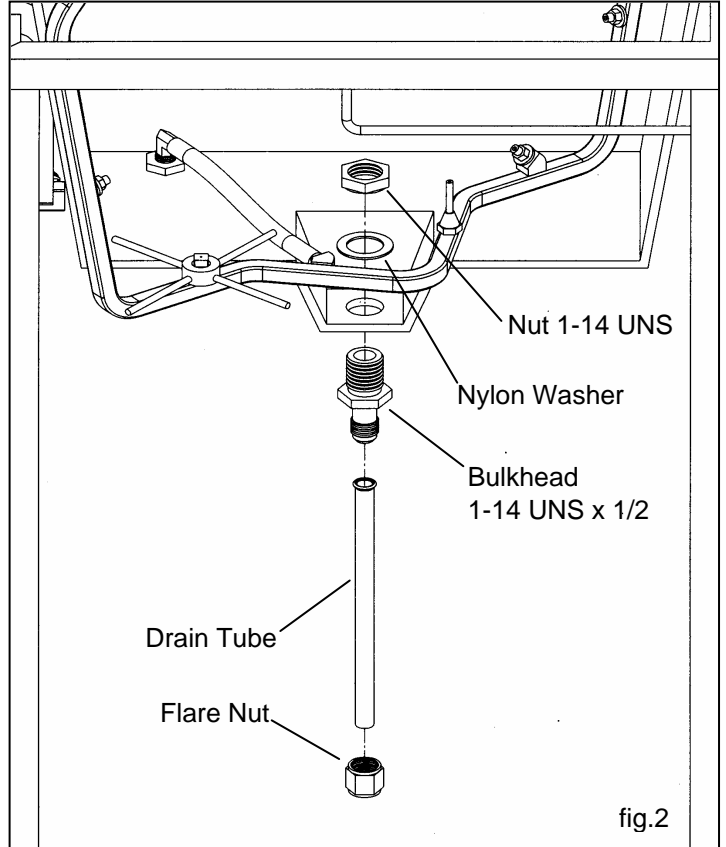
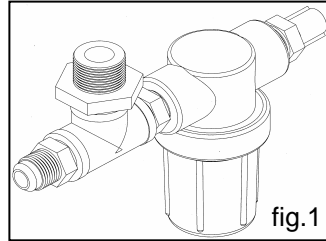

STEP 1

Begin by removing the old bulkhead and cleaning the area around the 1" diameter hole in the tub.

STEP 2

Insert the 1-14 UNS thread end up through the bottom of the tub and secure with the 1-14 UNS brass nut with the stepped edge facing the bulkhead and the nylon washer.

Note: Tighten the nut to the bulkhead using an impact gun if possible. The nut and bulkhead must be properly sealed to avoid future leaking of solvent.

STEP 3

Slide the flare nut over the flared tube and finger tighten to the bulkhead at the bottom of the tub.

Note: With the conversion of the pump, it is no longer necessary to use the ball cage assembly.

Steps 1-3 see fig. 2

STEP 4

Begin mounting the pump by positioning the bracket on the outside of the legs on the left side of the unit and mark locations for drilling through the leg.

Note: Drill size: .281". The holes should be positioned about 5.00" up from the bottom of the legs. The legs can be flexed slightly in for mounting if there is not ample material to drill through.

STEP 5

Drill through the legs and clear any burrs. Put the pump bracket in place, inside the legs, and attach using (1) 1/4-20 x 1/2" bolt, (1) 1/4" lock washer, (1) #10 flat washer and (1) 1/4-20 acorn nut for each side.

STEP 6

Position the pump so that the grounding bar is facing away from the unit and attach with (1) 1/4-20 x 1 bolt, (1) 1/4" flat washer, (1) 1/4" lock washer and (1) 1/4-20 nut for each side.

Steps 4-6 see fig. 3

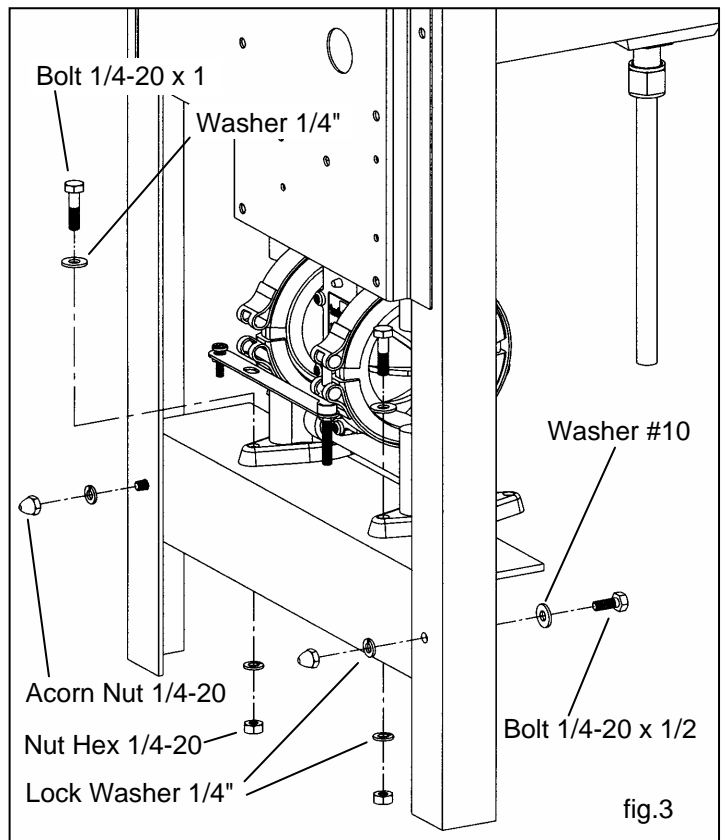

Assembly

STEP 7

Take the 23" length of black hose and insert the filter assembly into one end.

STEP 8

Slide the other end of the 23" black hose through the white plug so that the threads are towards the filter. Attach the other end of the hose to the lower (IN) fitting on the pump.

STEP 9

Attach the 21" length of black hose to the upper (OUT) fitting on the pump and connect the other end to the fitting on the base of the tub.

Note: Not all units have a 90° hose barb on the tub as shown.

STEP 10

Screw the muffler into the open port on the back of the pump.

Steps 7-10 see fig. 4

Note: The filter and drain tube are inserted into a 5 gallon solvent can and the plug secured in the opening of the can. The filter must be completely submerged in solvent for proper operation.

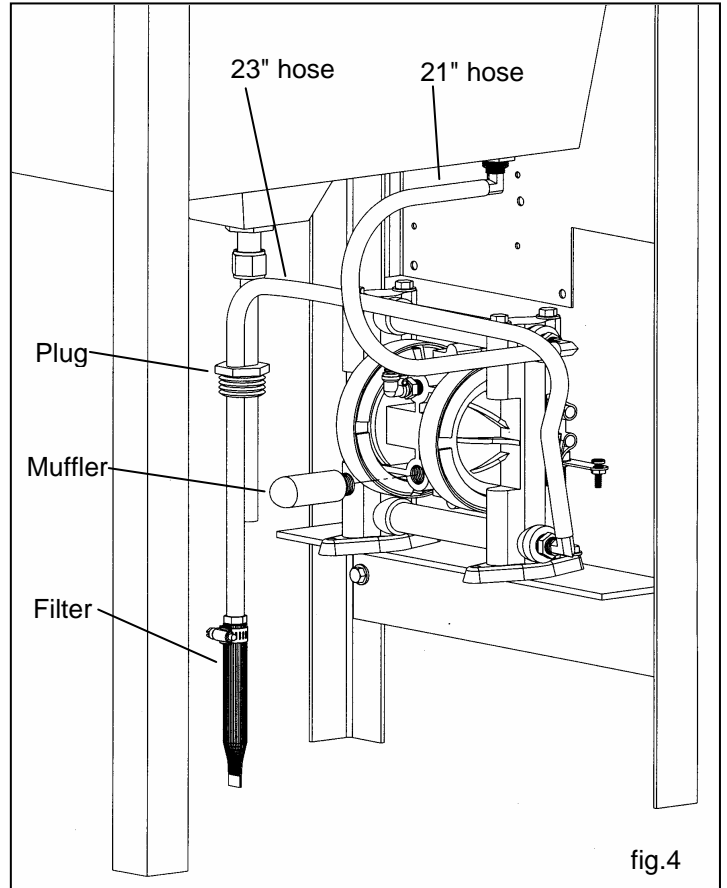

STEP 11

Remove the nut holding the filter/regulator to the shield assembly and disconnect the hose coming out of the back of the regulator.

STEP 12

Remove the fittings from the filter/regulator and attach them to the new filter/regulator in the same configuration.

Note: Make sure that the air inlet fitting is at the tail end of the flow arrow and the outlet fittings are at the head end. Fittings may be different than shown in fig. 5.

STEP 13

Re-attach the filter/regulator to the shield assembly using the same nut that was removed in step 11. The inlet fittings should be facing outwards from the unit.

Steps 11-13 see fig. 5

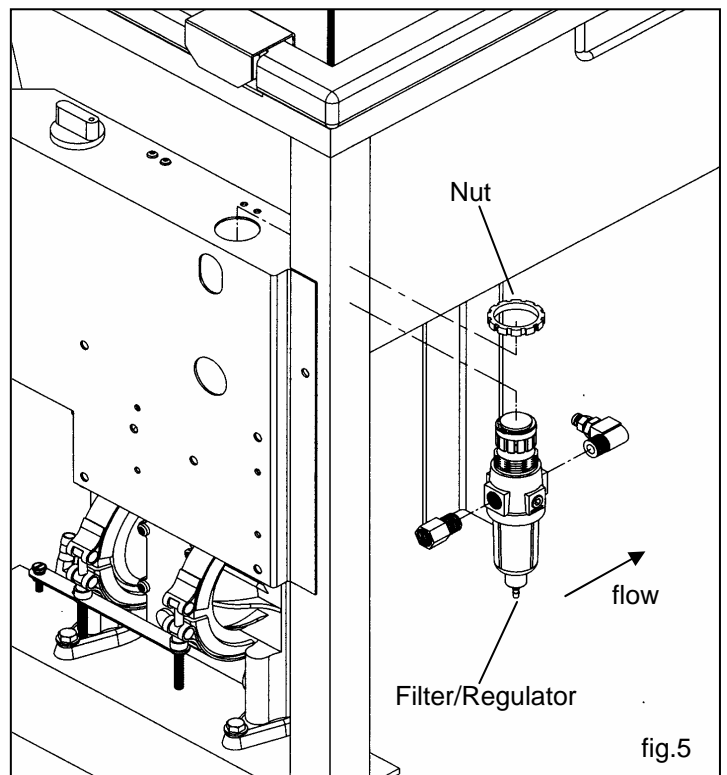

Assembly

STEP 14

Connect the hose from the IN port of the timer switch to the out from the Filter/Regulator. Ensure the hose from the OUT port of the timer switch runs to the IN port of the lid switch. If not, run the 15" length of blue hose from the OUT port of the timer switch to the IN port of the lid switch.

Note: The IN port of the switch is the port on the opposite side of the roller.

STEP 15

Run the 25" length of blue hose from the OUT port of the lid switch to the 90° swivel PTC fitting on the back of the pump.

Note: Connect air and turn on the unit and check for air leaks. If air is leaking, ensure all the blue hoses are completely inserted into the proper ports.

Steps 14-15 see fig. 6

STEP 16

The pump has two ground wires attached. Run one to a true earth ground and the other to one of the lid hinges at the back of the unit.

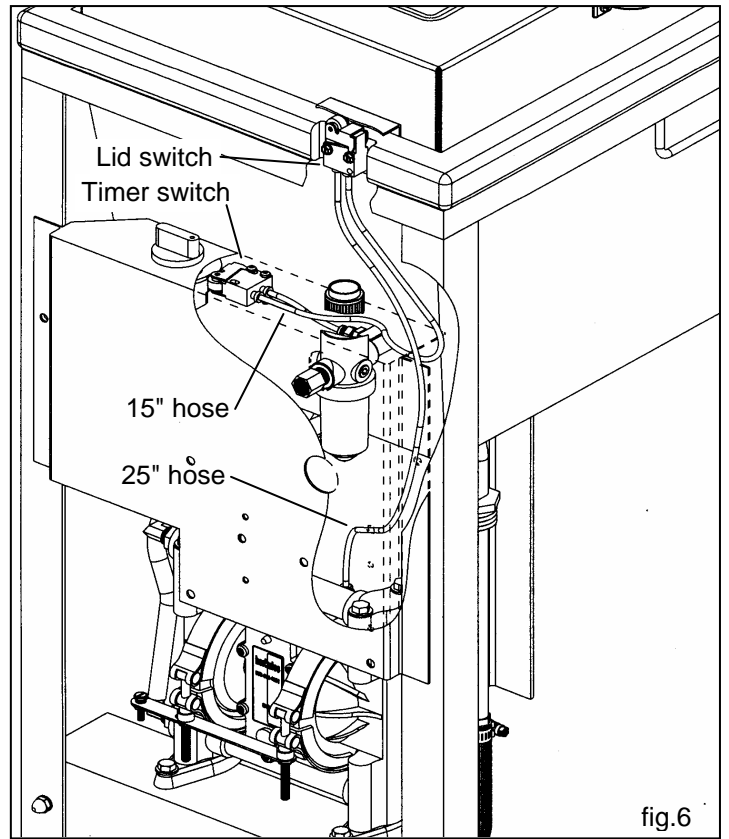

fig.6

Kit Information

Contents

001-702	Bolt hex 1/4-20 x 1/2	2 ea.
001-705	Washer flat 1/4"	2 ea.
002-161	Washer flat #10 USS	2 ea.
008-244	Acorn nut 1/4-20	2 ea.
11130	Plug with slot - white	1 ea.
11243	Filter assembly	1 ea.
11958	Pump bracket	1 ea.
12018	338 Pump assembly	1 ea.
12137	Drain tube	1 ea.
42	Bulkhead 1-14 UNS x 1/2 T - brass	1 ea.
44	Nut hex 1-14 UNS - brass	1 ea.
64PE	Hose for filter - black	23 in.
64PE	Hose for manifold - black	21 in.
83	Bolt hex 1/4-20 x 1	2 ea.
84	Nut hex 1/4-20	2 ea.
85	Lock washer 1/4	4 ea.
85B	Washer 1-1/2 x 1 - nylon	1 ea.
M5	Hose - lid switch to pump - blue	25 in.
M5	Hose - timer to lid switch - blue	15 in.
M52	Flare nut 1/2 T - brass	1 ea.
T17M	Filter/Regulator 75 psi	1 ea.

